

Ty-Care* Instructions for use

How to connect Ty-Care to breathing system

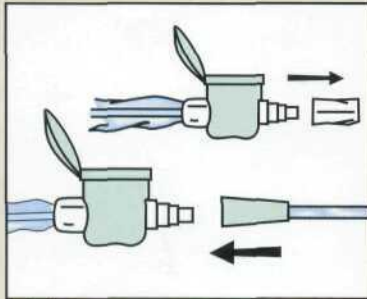

1 Remove protective cover, lift protection lid and connect suction valve to suction line.

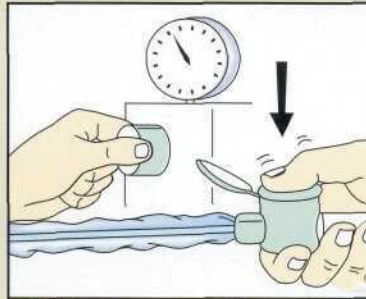

2 Set vacuum to desired level while depressing suction control valve.

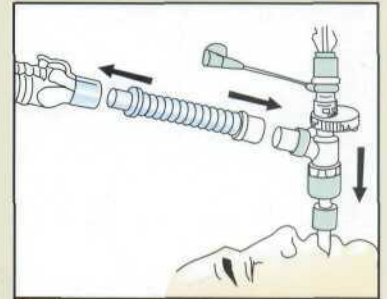

3 Connect Ty-Care to breathing circuit and tracheal/tracheostomy tube. If needed interpose the catheter mount between circuit and double swivel elbow.

How to perform suctioning

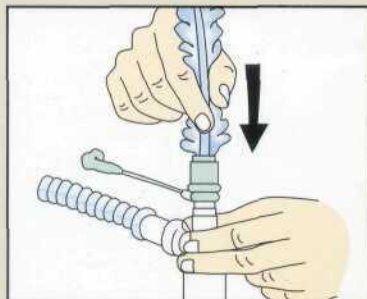

1 Insert suction catheter with one hand into tracheal/tracheostomy tube to desired depth. Maintain grip on elbow connector with the other hand.

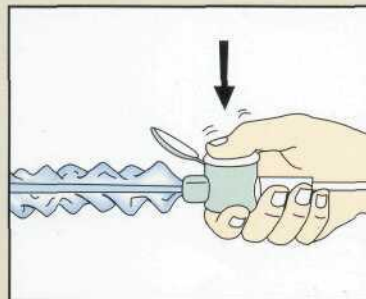

2 Apply vacuum by depressing suction control valve, whilst withdrawing suction catheter.

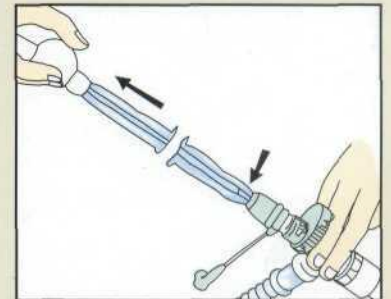

3 After suctioning, withdraw suction catheter until black tip marking is fully visible.

How to clean the suction catheter

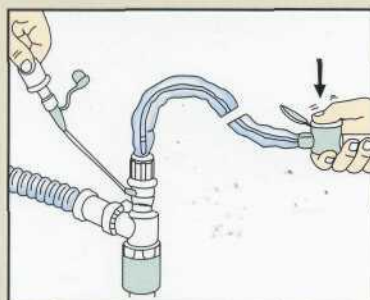

1 Connect vial or syringe to flushing port and inject solution while applying suction by pressing control valve.

How to administer aerosol using MDI port

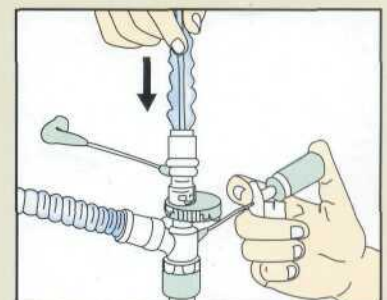

Remove the cap from MDI port and insert can tip with moderate pressure. Set the canister in vertical position and press canister during inspiratory phase. Remove canister and recap port.

CE 0123 Manufactured by: **Mallinckrodt DAR.**
via G. Bove, 2/4/6/81-41037 MIRANDOLA (MO) ITALY
Tel : +39 0535 617901 - Fax: +39 0535 617933

*TY-CARE is a proprietary trademark of Tyco Healthcare Group LP affiliate © 2002 Tyco Healthcare. All rights reserved.

C-BR/TyCIFUEX/GB



Tyco Healthcare India Pvt Ltd

130/81, 3rd Floor, Nelson Manickam Road, Chennai - 600 029.

Tel : 044 2374 6951-56 Fax : 044 2374 6958

E-mail : TechSupport.India@tycohealth.com.sg

tyco

Healthcare